



Phone: 940-365-5833

Fax: 940-365-5834

5097 U. S. Hwy 377

Krugerville, Texas 76227

Driveway Culvert Application

Project Address:

Lot: _____ Block: _____ Subdivision: _____

Owner Information:

Name: _____ Contact Person: _____

Address: _____

Phone Number: _____ Fax Number: _____ Mobile Number: _____

Contractor	Contact Person	Phone Number	Fax Number

Signature of Applicant: _____

Date: _____

THE CITY MUST RECEIVE THE FOLLOWING, ALONG WITH THE \$500 CULVERT APPLICATION FEE, BEFORE ANY CULVERT APPLICATIONS WILL BE REVIEWED.

- 1 One copy of a site plan which details the location of the proposed driveway culvert and design calculation indicating that the culvert is adequate to carry the 100 year frequency storm. The scale on the plan should be no smaller than one (1) inch = 50 feet.
- 2 Written specifications indicating overall dimensions of proposed culvert, including headwalls, depth and width of the drainage ditch, and the distance of the proposed installation site from the connecting roadway, together with the specification of the material to be used.
- 3 Upon approval of application, a permit for installation will be issued by the City and construction may commence.
- 4 A certified culvert certificate must be prepared and received by the Inspector before final inspection will be approved.
- 5 Driveway construction is to be approved by the Building Inspection Department under the building permit.
- 6 Culverts in highway department R.O.W. will require a copy of the approved highway department permit and a copy of the highway department application package to be submitted with application.
- 7 Denied or unapproved requests may be subject to pass through costs in excess of the \$500 standard fee.

OFFICE USE ONLY:

Approved by:	_____	Date approved:	_____
--------------	-------	----------------	-------

Paid: _____
 Check #: _____
 Date: _____

Total Fees: _____
 Issued Date: _____
 Issued By: _____



DATE: _____

Mayor and City Council
City of Krugerville
5097 US Hwy 377
Krugerville, Texas 76227

RE: Certificate of Driveway Culvert Installation

Dear Mayor:

As a registered professional land surveyor in the State of Texas, I hereby certify that the culvert for the driveway for Block _____, Lot _____ of _____
_____ addition Phase _____, has been installed in accordance with the lines and grades indicated on the approved construction plans. In accordance with the lines and grades _____
_____ for the development. The survey information is indicated on the attached exhibit.

Respectfully Submitted

RPLS Number

(Engineer's Seal)

(TO BE SUBMITTED WITH CULVERT CERTIFICATE)



COUNTYWIDE INSPECTION SERVICES

Permit Submittal

All completed permit documents shall be submitted to City Hall. Processing time is 7 to 10 days.

Permit Issuance

Once the permit has been approved, the requestor will be contacted by City Hall personnel and notified of fees.

Plan Review

Countywide Inspection Services will be conducting residential and commercial plan reviews. The applicant will be contacted by Countywide if additional information is needed. You may contact City Hall for the status of your permit at 940-365-5833.

Inspection Requests

Please contact Countywide Inspection Services to request inspection(s). Any of our permit technicians can assist you. Inspections shall be requested 24 hours in advance. Those inspections requested during normal business hours, will be performed the next business day.

Inspection line: 940-521-0470
Email: countyinspections@gmail.com

Field Inspections

Your inspectors' names are Mike Doughty (940-284-5677) and Manny Villarreal (817-353-930).

We look forward to working with you to ensure that the community is provided with a safe and durable built environment.

DRIVEWAY CULVERT DESIGN
ADDRESS
CITY, STATE

COMPANY
INFORMATION

NO.	DATE	DESCRIPTION

SEAL

SEAL AUTHORIZATION

PROJECT NO.	
DRAWN BY	
CHECKED BY	
S-SCALE	
SHEET TITLE	
SHEET NUMBER	

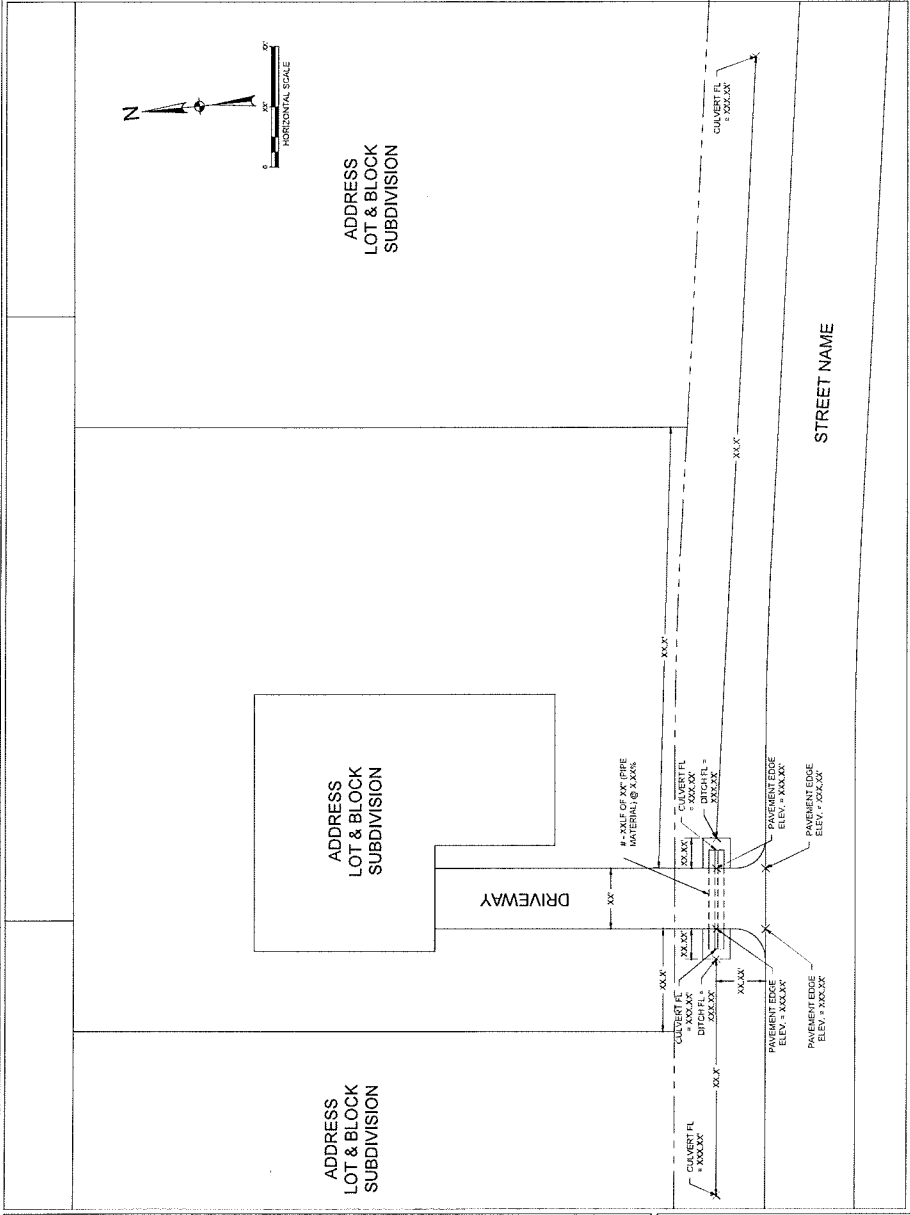

DRAINAGE CALCS

DETAILS

NOTES

Downstream Existing Culvert Flowline = _____
 Distance from Proposed Culvert to Downstream Existing Culvert = _____
 Upstream Existing Culvert Flowline = _____
 Distance from Proposed Culvert to Upstream Existing Culvert = _____
 Proposed Culvert Inlet Flowline = _____
 Proposed Culvert Effluent Flowline = _____
 Proposed Culvert Grade = _____
 Proposed Culvert Length = _____
 Proposed Culvert Diameter = _____
 Proposed Culvert Material = _____
 Distance from Proposed Culvert to Upstream Property Line = _____
 Distance from Proposed Culvert to Downstream Property Line = _____
 Distance from Proposed Centerline to Edge of Street Pavement = _____
 Length of Upstream Headwall = _____
 Elevation of Downstream Headwall = _____
 Elevation of Street Pavement Edge Above Downstream Flowline = _____
 Elevation of the Driveway Pavement Edge Above Downstream Flowline = _____
 Elevation of Street Pavement Edge Perpendicular to Upstream Flowline = _____
 Elevation of Street Pavement Edge Perpendicular to Downstream Flowline = _____